



Side View Camera Instruction Sheet

Tech Support 1-800-265-1818
<http://usa.vdo.com>

Instruction Sheet # A2C59519839

Rev. -

Mounting Instructions

- 1) Remove the four screws that fasten the camera casing
- 2) Place the sealant pad below the bottom bracket
- 3) Apply all the screws in the five mounting hole locations
- 4) Next refer to the Adjustment instructions to adjust the camera properly

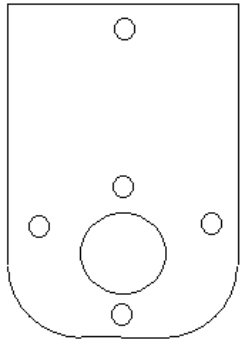

Adjustment Instructions

To adjust the camera for right or left side views:

- 1) Remove the four screws that fasten the camera casing
- 2) Use hole on bottom of casing to remove bottom
- 3) Adjust camera to desired viewing angle
- 4) Reattach casing, ensure that the groove on the back of the casing lines up with the notch on the bottom of the casing.
- 5) Tighten all four screws on the outside of the casing.

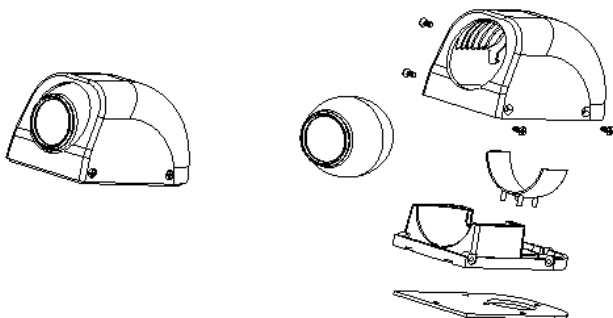

Merchandise warranted against defects in factory workmanship and materials for a period of 24 months after purchase. This warranty applies to the first retail purchaser and covers only those products exposed to normal use or service. Provisions of this warranty shall not apply to a VDO product used for a purpose for which it is not designed, or which has been altered in any way that would be detrimental to the performance or life of the products, or misapplication, misuse, negligence or accident. On any VDO part or VDO product found to be defective after examination by manufacturer, manufacturer will only repair or replace the merchandise through the original selling dealer. Manufacturer assumes no responsibility for diagnosis, removal and/or installation labor, loss of vehicle use, loss of time, inconvenience or any other consequential expenses. The warranties herein are in lieu of any other expressed or implied warranties, including any implied warranty or merchantability of fitness, and any other obligation on the part of manufacturer, or selling dealer.

Read these instructions thoroughly before installation. Do not deviate from assembly. Always disconnect battery ground before making any electrical connections.

Parts List

Item	Description	Qty
1	Side View Camera (6-20V) DC	1
2	Mounting Kit	1
3	Instruction Sheet	1

Connect the camera to the display:

Take the 4 pin female camera connection and plug it into the 4 pin male connection coming from the display wire harness. Make sure that the small groove on the camera connector lines up with the groove on the display wire harness.

Next tighten the connection by turning the cable lock in a clockwise fashion until the connection is tight.

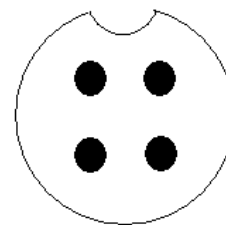

Camera
(Female)

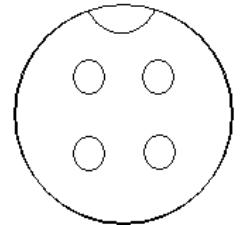

Display Wire
Harness
(Male)